

Model: Finisher for the AD50		Date: 15-Sep-97	No: 1
Subject: New Product Information		Prepared by: S.Tomoe	
From: QAC 2nd Field Information Dept.			
Classification:	<input type="checkbox"/> Troubleshooting	<input type="checkbox"/> Part information	<input type="checkbox"/> Action required
	<input type="checkbox"/> Mechanical	<input type="checkbox"/> Electrical	<input checked="" type="checkbox"/> Service manual revision
	<input type="checkbox"/> Paper path	<input type="checkbox"/> Transmit/receive	<input type="checkbox"/> Retrofit information
	<input type="checkbox"/> Other (      )		

The new Finisher (SR710) is being developed as a peripheral for the AD50, which will be launched this November. This RTB clarifies the differences between the SR700 and the SR710.

### 1. Model Name and Machine Code

Brand Name	Ricoh	NRG	Infotec	Savin
Machine Code	A612-57	A612-62	A612-66	A612-55
Model Name	SR710			

### 2. Technical Information

All information in the service manual is the same as that for SR700 except for the following items.

#### 1) Increased paper speed at the entrance of the unit

The AD50 copy speed is 50 cpm. So, the paper speed at the entrance of the unit has been increased from the SR700 (200 mm/s → 250 mm/s). Therefore, the transport drive motor has been changed.

#### 2) Two grounding plates have been removed

Due to a change in the European Radiation Standard Class (EN55022) of the AD50 from class B to class A, two grounding plates are no longer necessary to install the unit. Therefore, the installation procedure of the finisher has been changed (refer to the attached installation procedure).

## INSTALLATION PROCEDURE

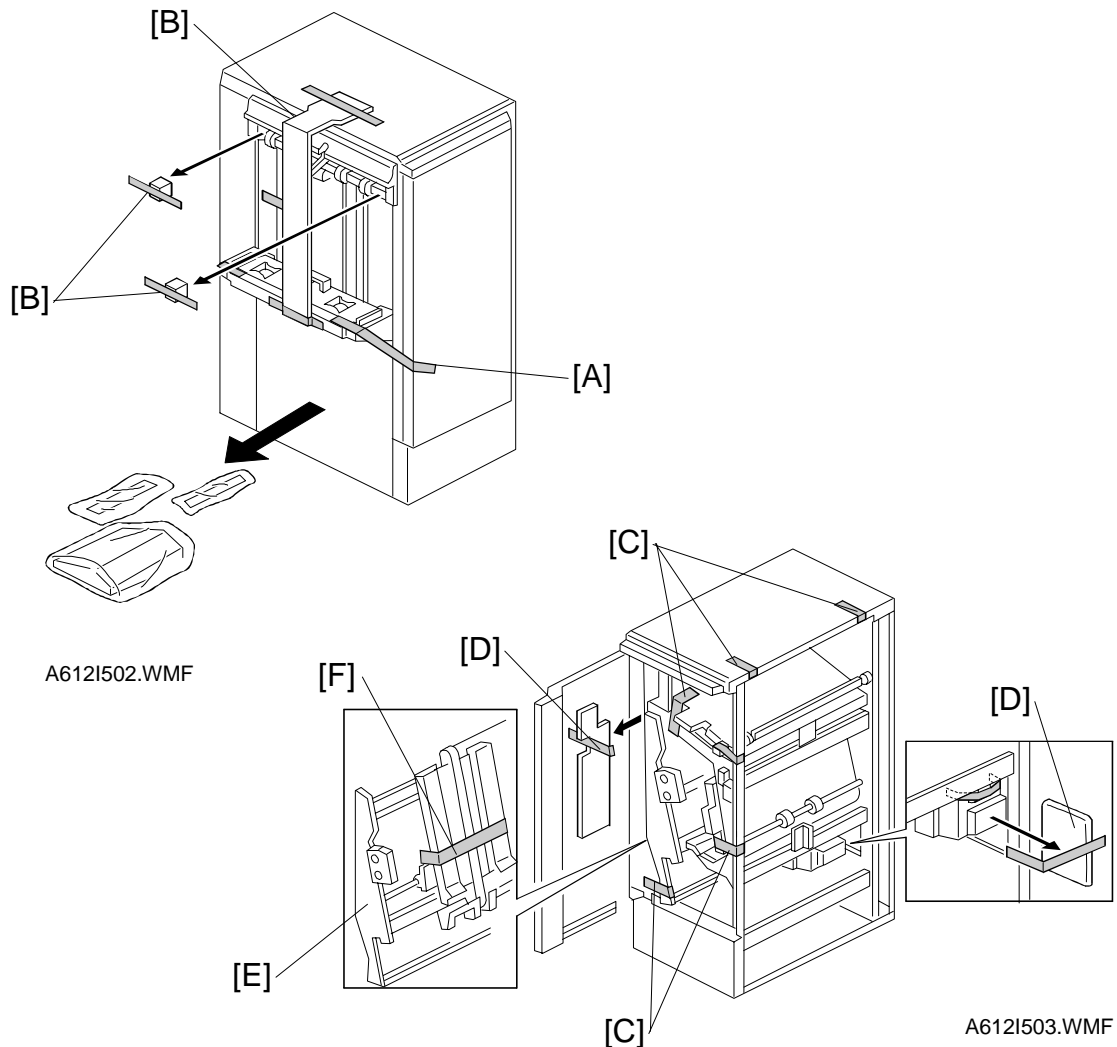

### **⚠ CAUTION**

**Unplug the power cord before beginning the following procedure.**

1. Remove the strip of tape [A] and the cushions [B].
2. Open the front door and remove the strips of tape [C] and cushions [D].
3. Pull out the staple unit [E].
4. Remove the strip of tape [F].

Model: Finisher for the AD50	Date: 15-Sep-97	No: 1
------------------------------	-----------------	-------

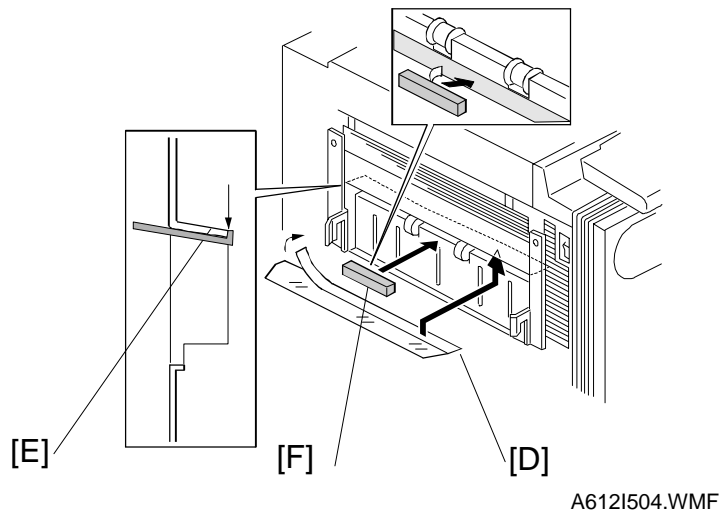
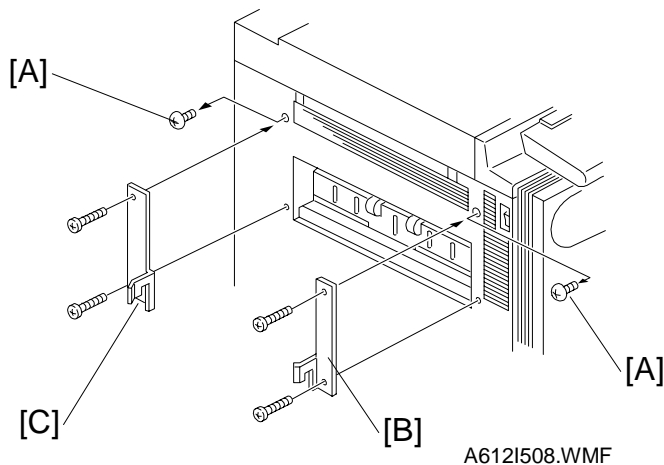

5. Remove the screws [A] from the left cover.
6. Install the front connecting bracket [B] (2 screws— M4 x 12) and the rear connecting bracket [C] (2 screws— M4 x 12).
7. Attach the mylar strip [D] to the copy exit area, as shown.  
**NOTE:** Carefully align the edge of the cover [E] with the mylar guide.
8. Attach the cushion [F] to the lower exit plate, as shown.

Model: Finisher for the AD50	Date: 15-Sep-97	No: 1
------------------------------	-----------------	-------

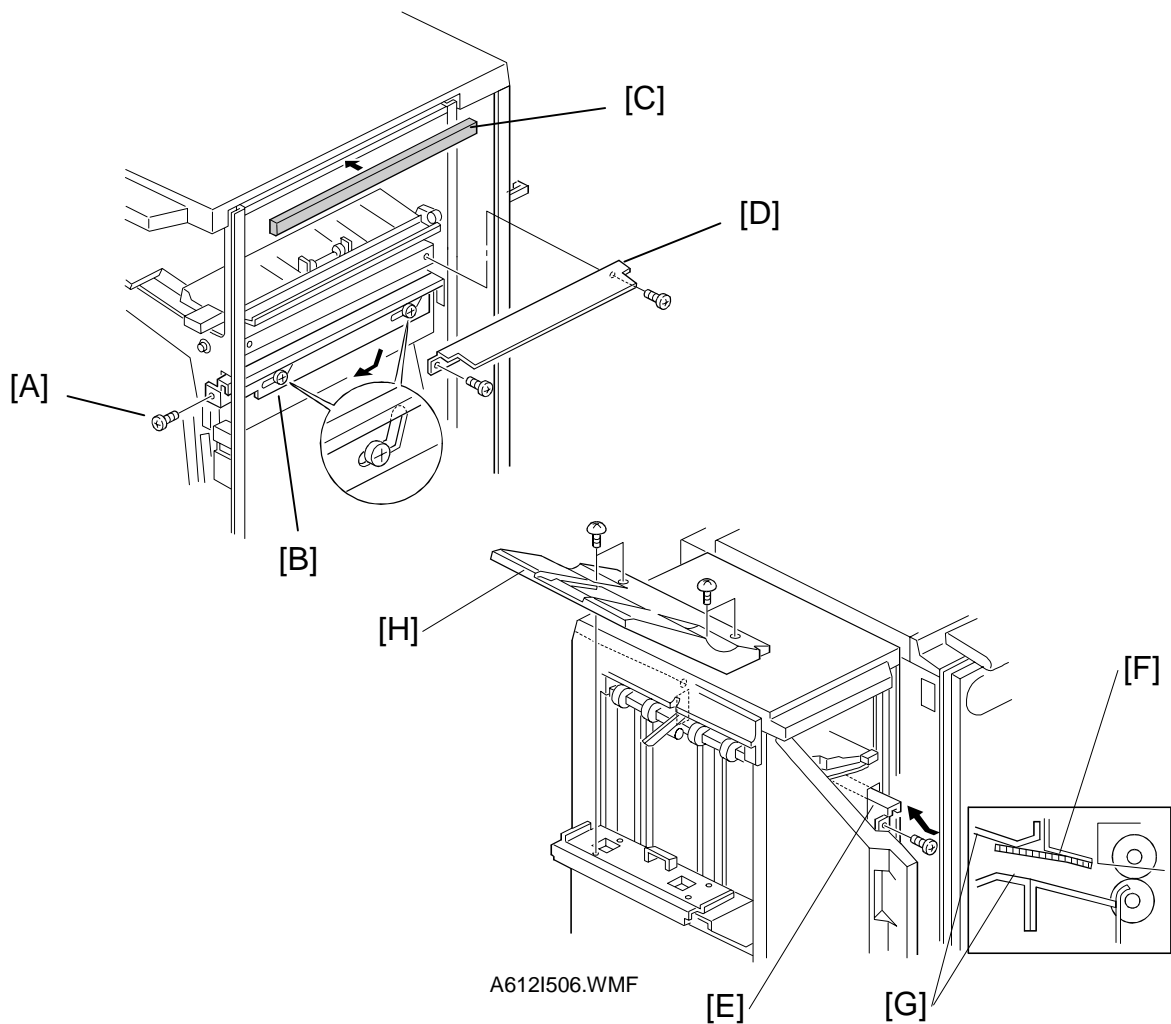

9. Open the front door of the finisher and remove the screw [A] which secures the locking lever [B]. Then pull the locking lever (This causes the lever to move out and down).
  10. Attach the cushion [C] to the metal stay (not to the cover) as shown.
  11. Install the entrance guide plate [D] (2 screws -M4 x 6).
  12. Align and install the finisher on the connecting brackets. Lock them in place by raising the locking lever [E].
- NOTE:** Ensure that the mylar strip [F] is located between the guides [G].
13. Install the shift tray [H] (4 screws — M4 x 8).

Model: Finisher for the AD50

Date: 15-Sep-97

No: 1

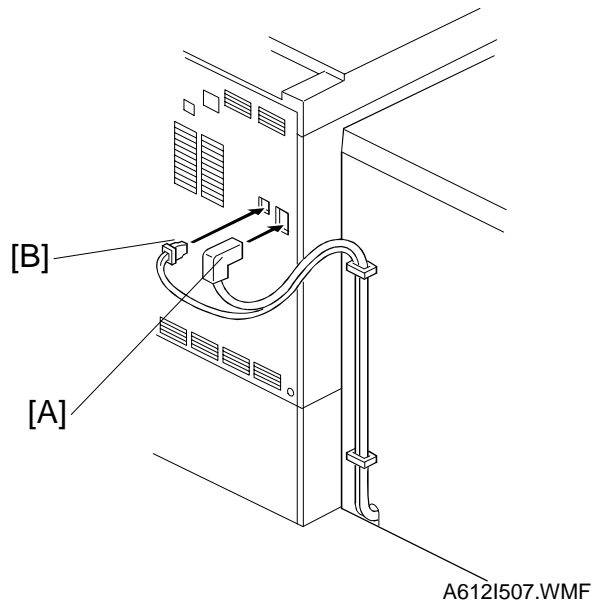

14. Reinstall the rear cover.

15. Connect the cable [A] and the fiber optic connector [B].

16. Plug in the copier.

17. Turn on the main switch and test the newly installed finisher's operation.

**NOTE:** The copier automatically recognizes that the finisher has been installed. The stapler will begin stapling after about 10 copies (This is how long the first staple takes to come to the proper position in the cartridge).

Model: Finisher for the AD50		Date: 30-Sep-97	No: 3
Subject: SC101		Prepared by: E.Fukuyama	
From: QAC 2nd Field Information Dept.			
Classification:	<input checked="" type="checkbox"/> Troubleshooting	<input type="checkbox"/> Part information	<input type="checkbox"/> Action required
	<input type="checkbox"/> Mechanical	<input type="checkbox"/> Electrical	<input type="checkbox"/> Service manual revision
	<input type="checkbox"/> Paper path	<input type="checkbox"/> Transmit/receive	<input type="checkbox"/> Retrofit information
	<input type="checkbox"/> Other (      )		

For machines on which the Finisher is installed, if a large amount of copies is made right after power-up, SC101 may occur. If the Entrance Guide is installed in the proper position, this problem may be prevented. Please refer to the attached page for the installation procedure.

**Symptom**

SC101 occurs.

**Cause**

If the Entrance Guide is not installed in the proper position, a gap may develop between the Cover and the Main Frame through which the heat and humidity generated by the paper may enter and lead to high temperature/high humidity around the lamp stabilizer. If a large amount of copies is made right after the machine is turned on, the Lamp Stabilizer will warm up very quickly and may lead to condensation. This may lead to a short circuit and cause SC101.

**Countermeasure**

The edges of the Entrance Guide have been bent to strengthen this part and make it easier to install. Please refer to SR710 MB#2 for the details regarding this modification.

**ACTION**

During the set-up of a Finisher manufactured after May 1997, please install the Entrance Guide in a manner that will prevent a gap from developing between the Cover and the Main Frame. Please refer to the attached page for this procedure.

In the event that an SC101 occurs on a Finisher manufactured before April 1997, please replace the Entrance Guide with part number A6122333.

Model: Finisher for the AD50

Date: 30-Sep-97

No: 3

## Entrance Guide Installation Procedure

1. Peel off the tape seal for the Entrance Guide.
2. Place the Entrance Guide on the Main Frame.
3. Attach the Entrance Guide to the Cover.

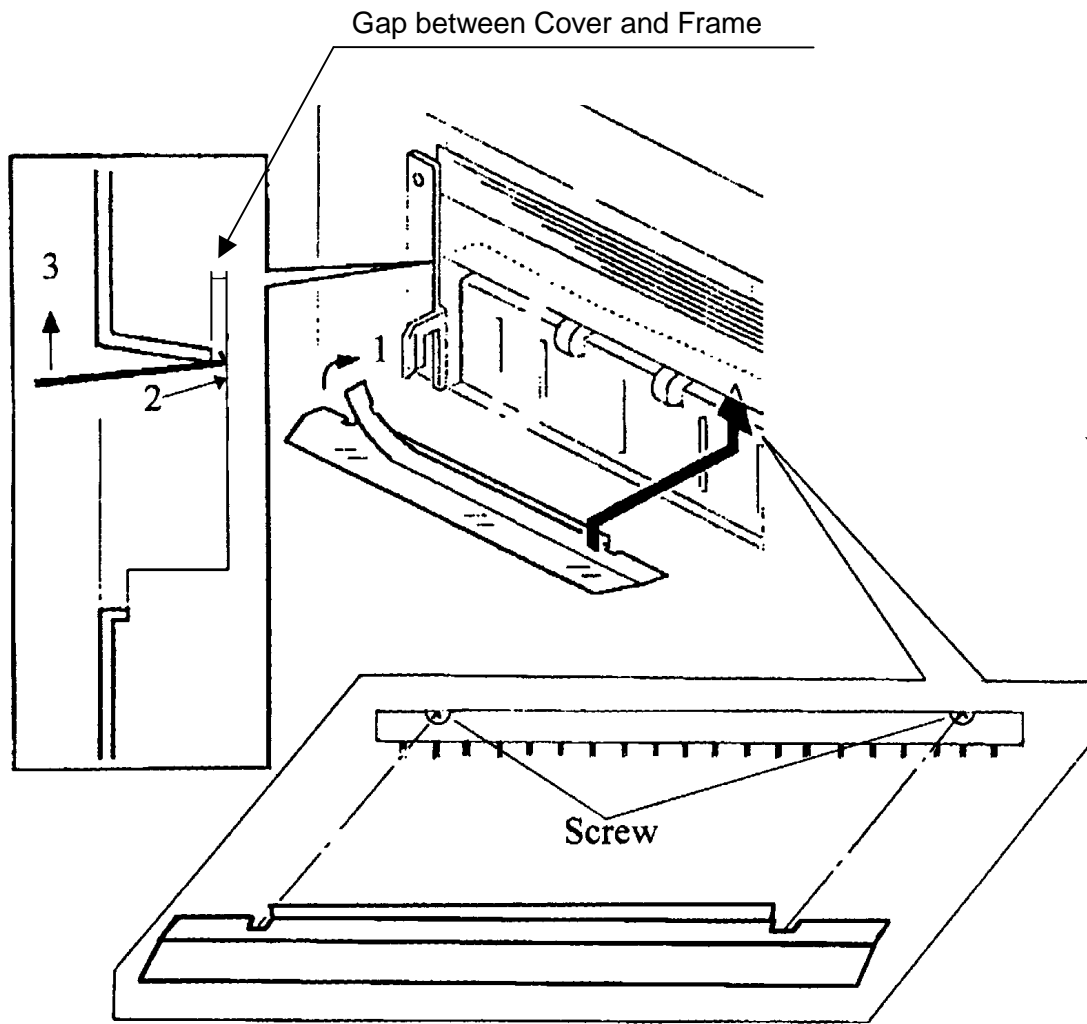

New Entrance Guide